

VICTOR



Multi-Kill®



ELECTRONIC MOUSETRAP
INSTRUCTIONS

www.victorpest.com



Multi-Kill® ELECTRONIC MOUSETRAP INSTRUCTIONS

Thank you for your purchase of the Multi-Kill® Electronic Mousetrap, the world's most advanced mousetrap. This device was developed by Victor®, your trusted rodent control expert for over 100 years.

1

Make certain the power switch is depressed to the "OFF" (O) position.



2

Open the kill chamber door. Insert a small amount of peanut butter (the size of a pea) against the back wall of the kill chamber.

Be sure to never place peanut butter or any other material directly on the metal plates as this will not allow a proper connection between the mouse and the plate.

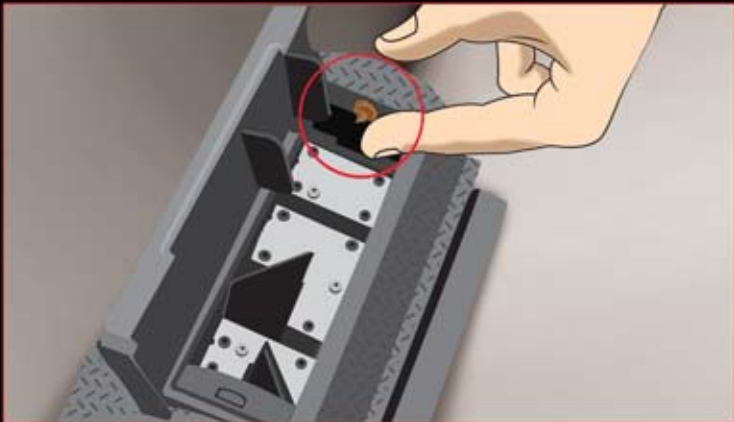

3

Open the battery compartment lid. Pull out the (4) C batteries. Remove the plastic from the batteries. Properly reinsert the batteries. Close the battery compartment lid.

**4**

Identify a location with mouse activity. Place the trap with its stairs oriented against the wall in an area where activity has been seen.

**5**

Depress the power switch to the "ON" (I) position. The green light will flash once to indicate the trap is working.



6

Once a mouse (mice) is caught, depress the power switch to "OFF" (0) position. Pull open the rodent receptacle and dispose of rodent(s)



To keep your trap in peak condition - it is important to empty your trap as soon as you see the kill indicator light flashing. Additionally, cleaning the trap by wiping the metal plates and drawer with a damp cloth after every 10 kills will improve the life of your trap. Do not use soaps as the scent could have a repelling effect ***

*** Remove the batteries prior to cleaning your trap. Allow the trap to air dry prior to reinserting the batteries and turning on the trap.

This system is for mice only.

Indicator Light Status:

- Blinks Once** ● **POWER ON** → Check trap daily
- Blinks Steady** ● **MOUSE KILL** → Empty rodent receptacle
- Blinks Steady** ● **RODENT RECEPTACLE FULL** → Empty rodent receptacle
- Blinks Fast** ● **PROBLEM** → Call 1-800-800-1819 Option 1
- Blinks Slow** ● **BATTERY LOW** → Change batteries

For other tips, visit www.victorpest.com

US Patents 6,735,899, 6,796,081, 6,836,999, 7,219,466 and other patents pending.

Woodstream 69 N. Locust St., Lititz PA 17543 1-800-800-1819 Option 1 Model#: M260

CAUTION:



Inappropriate use may cause Electric Shock. For Indoor use only. The device is not suitable for use in barns, stables and similar locations. The appliance is not to be used in locations where flammable vapor or explosive dust is likely to exist. This appliance is not intended for use by persons (including children) with reduced physical, sensory or mental capabilities, or lack of experience and knowledge, unless they have been given supervision or instruction concerning use of the appliance by a person responsible for their safety. Children should be supervised to ensure that they do not play with the appliance.

See product warning for additional details.

Note: Woodstream is not responsible for damage to this product that results from misuse of the product with actions contrary to these instructions. Please call us at 1-800-800-1819 Option 1 if you have additional questions.

This device has a One Year Limited Warranty.